

(C) This drawing is copyright. DO NOT SCALE FROM THIS DRAWING. Dimensions to be checked on site prior to work being carried out. This drawing is for the purpose of submitting a planning application only and it is to be read in conjunction with all other drawings and information in connection with the scheme. Any discrepancies to be reported to Callingham Associates Limited in writing prior to works proceeding. No unauthorised copying or reproducing of this drawing without prior written permission from Callingham Associates Limited

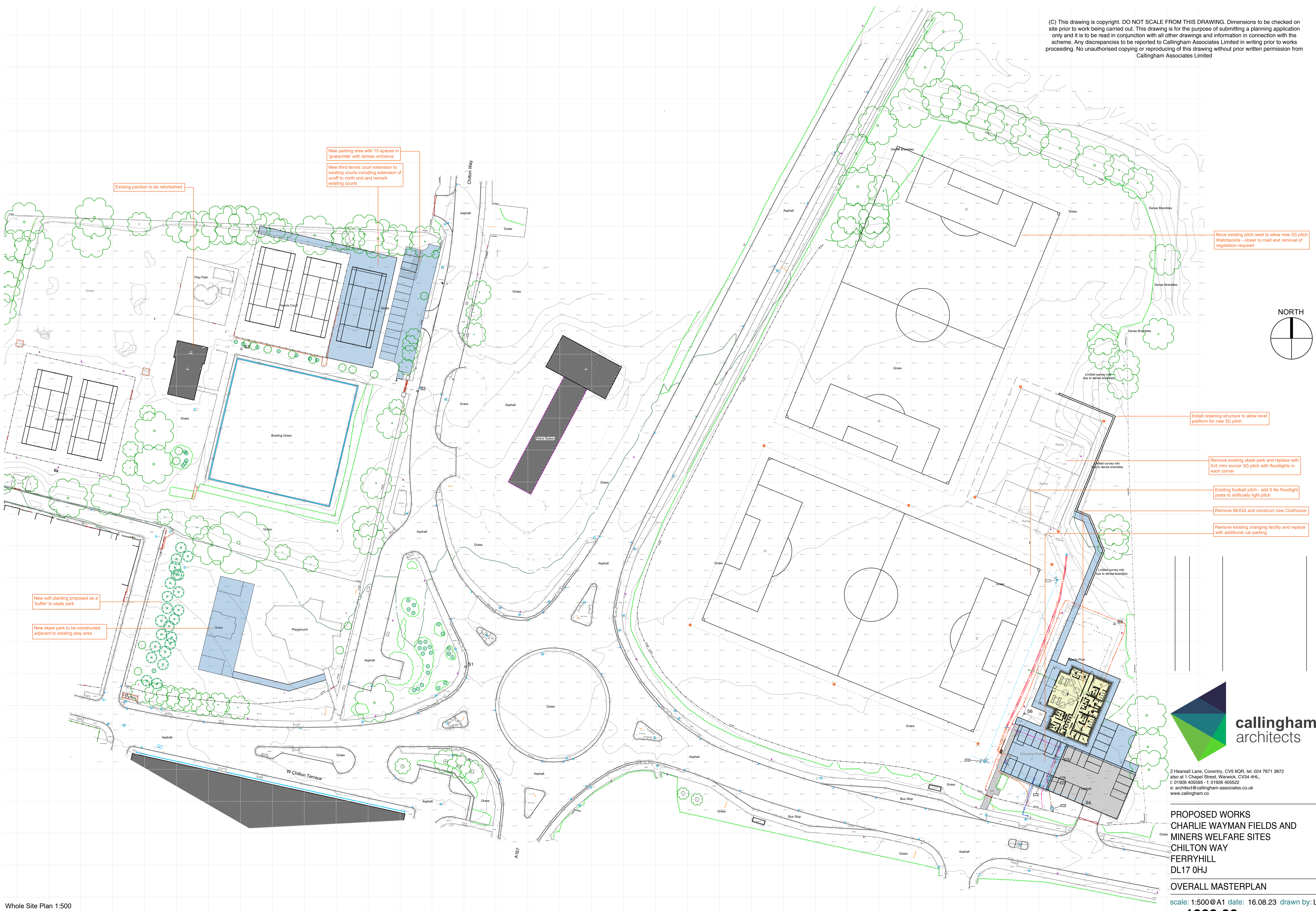

Existing pavilion to be refurbished

New parking area with 15 spaces in 'grasscrete' with tarmac entrance
New third tennis court extension to existing courts including extension of unoff to north end and remark existing courts

Move existing pitch west to allow new 3G pitch
Watchpoints - closer to road and removal of vegetation required



Install retaining structure to allow level platform for new 3G pitch

Remove existing skate park and replace with 5v5 mini soccer 3G pitch with floodlights in each corner

Existing football pitch - add 6 No floodlight posts to artificially light pitch

Remove MUGA and construct new Clubhouse

Remove existing changing facility and replace with additional car parking

New soft planting proposed as a 'buffer' to skate park

New skate park to be constructed adjacent to existing play area



2 Hearsall Lane, Coventry, CV5 6QR, tel: 024 7671 3872
also at 1 Chapel Street, Warwick, CV34 4HL,
t: 01926 405595 - f: 01926 405522
e: architect@callingham-associates.co.uk
www.callingham.co

PROPOSED WORKS
CHARLIE WAYMAN FIELDS AND
MINERS WELFARE SITES
CHILTON WAY
FERRYHILL
DL17 0HJ

OVERALL MASTERPLAN
scale: 1:500@A1 date: 16.08.23 drawn by: LC
drg: **1329.06** checked by: xx

Whole Site Plan 1:500
0m 10m 20m