

ALL DIMENSIONS TO BE CHECKED AND CONFIRMED ON SITE

BUILDERS NOTE

THIS IS A TYPICAL SECTION THROUGH THE PROPOSED RETAINING WALL FOR THE ASSUMED MAX. RETAINED HEIGHT.

HEIGHT OF RETAINING WALLS, LEVEL OF WEEPHOLES & PROPRIETARY DRAINAGE SYSTEM TO SUIT GROUND LEVELS ON SITE.

Apethorn Lane

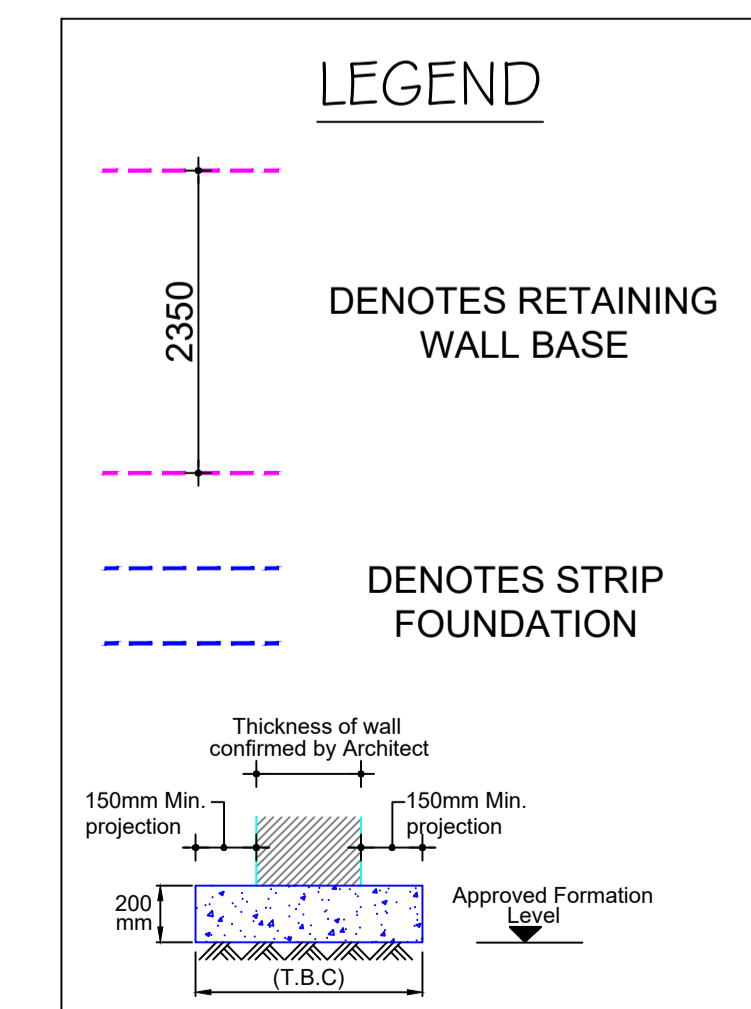
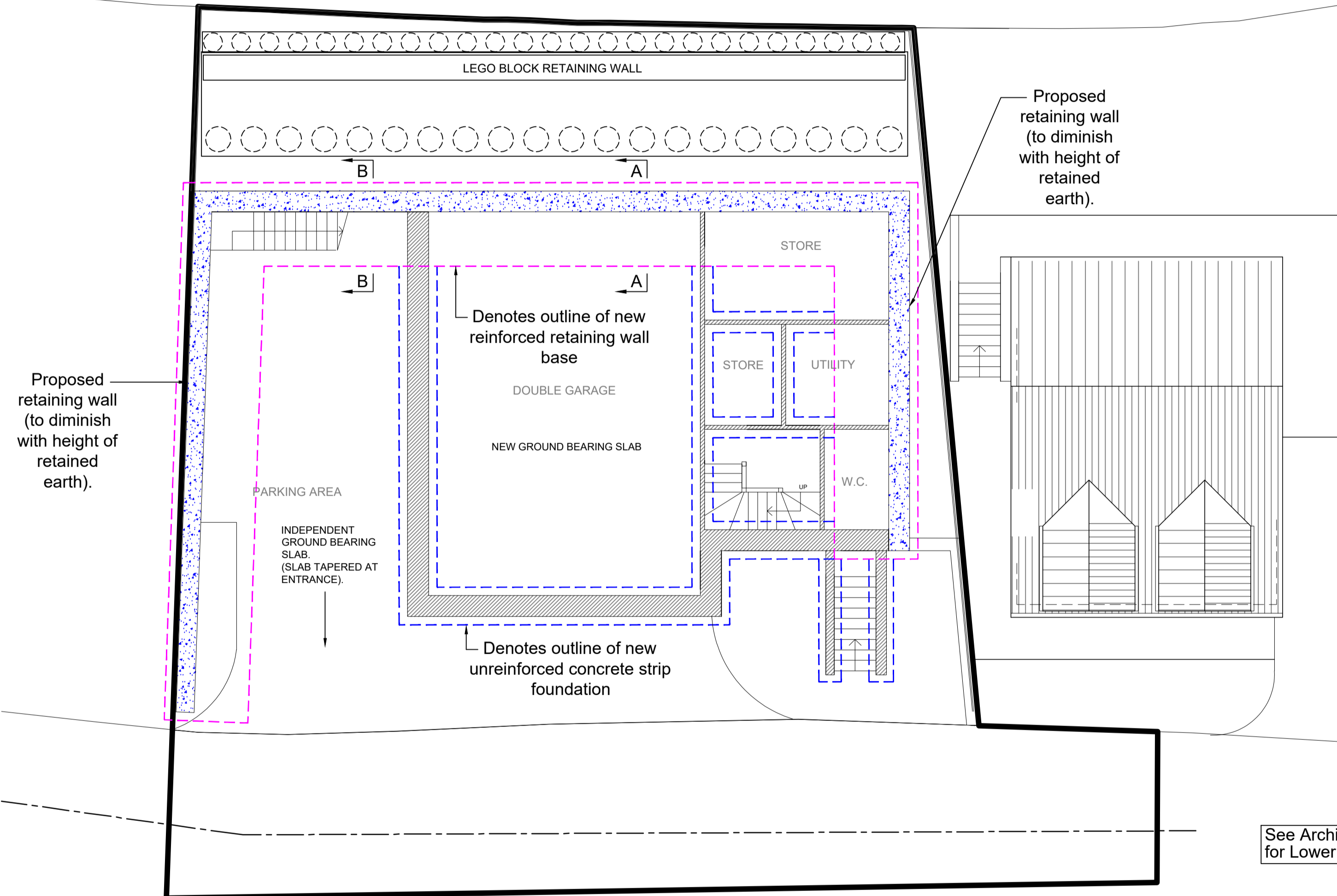

Proposed Foundation Plan (1:75)

INITIAL SITE SURVEY HAS NOT DETERMINED CONDITION, DIAMETER, SYSTEM TYPE OR DIRECTION OF BELOW GROUND DRAINAGE RUNS. CONTRACTOR MUST EXCAVATE & LOCATE FOUL & SURFACE WATER DRAINS AND ALTER AS NECESSARY TO THE APPROVAL OF THE LOCAL AUTHORITY. DRAINAGE LAYOUT SHOWN IS INDICATIVE ONLY.

BUILDING OVER EXISTING PUBLIC SEWERS-
ALL FOUNDATIONS WITHIN 1 METRE OF EXISTING PUBLIC SEWERS TO BE NO LESS THAN 150mm BELOW INVERT LEVEL OF DRAIN.
ALL LOAD BEARING WALLS TO HAVE RC LINTELS OVER SEWER & BACKFILLED WITH SUITABLE GRANULAR MATERIAL ALL IN ACCORDANCE WITH THE LOCAL WATER AUTHORITY GUIDANCE NOTES.

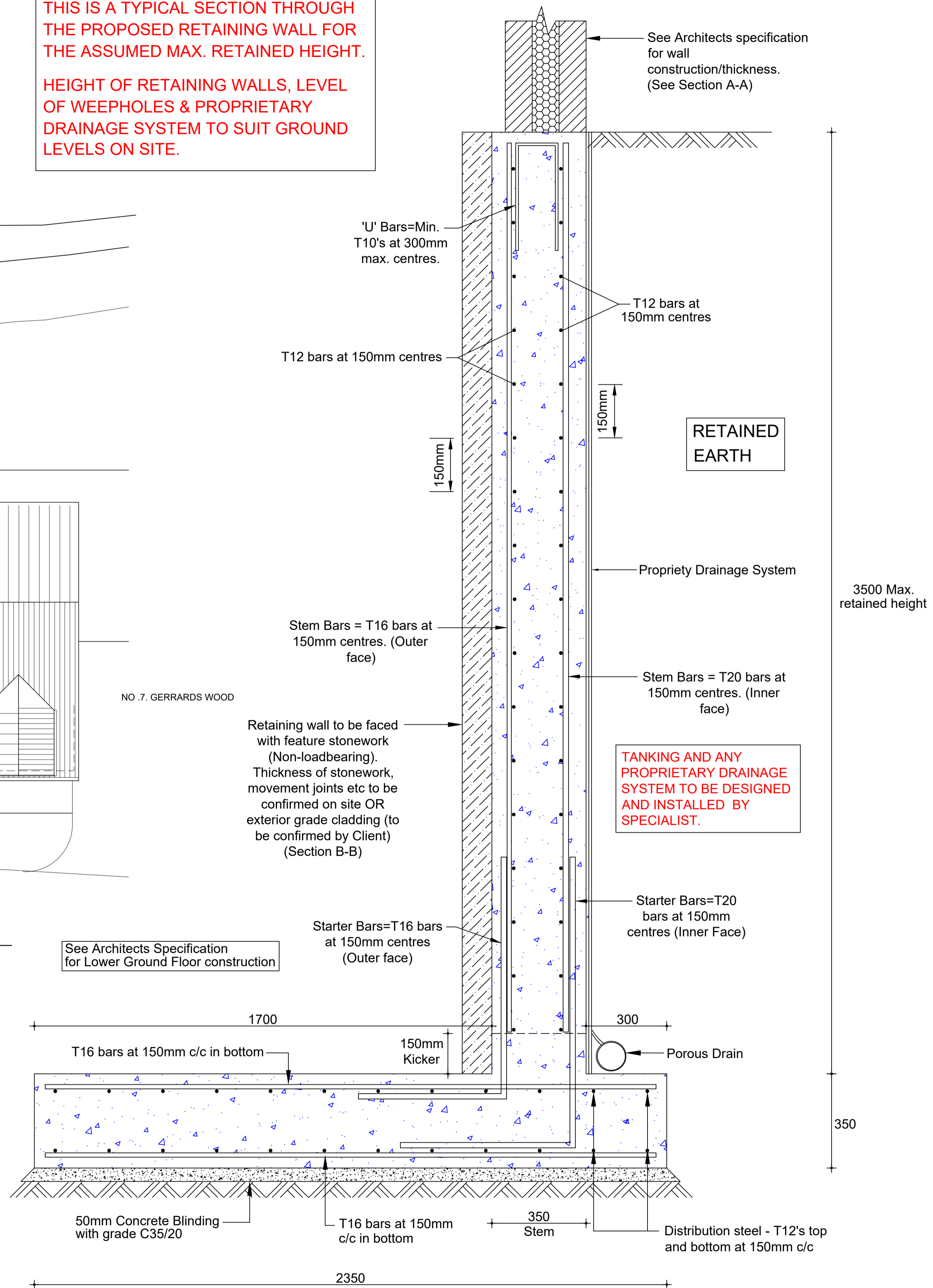

Enlarged Section through R.C Retaining Wall (1:10)

Section A-A (with house wall)
Section B-B (Exterior faced wall)

GENERAL NOTES

All dimensions are in millimetres unless otherwise noted.
Contractor to be responsible for checking all dimensions on site prior to work commencing.

All work to be carried out in accordance with British Standards and Codes of Practice.

Contractor to be responsible for all necessary temporary support and bracing to ensure stability of the building during the

RETAINING WALL
Concrete to be grade C35 having a crushing strength of 35N/mm² at 28 days.

Cement content to be 300kg/m³.

Aggregate to be 20mm maximum size. Max. free water/cement ratio to be 0.60. High yield reinforcement T bars to be type 2 bond bars as described in BS8110 with a characteristic tensile strength of 460N/mm².

Test cubes to be taken as directed by the Engineer.

All concrete to be compacted to the specification or by the means approved by the Engineer.

Concrete cover to be 50mm. Filling behind wall to be lightly compacted free draining hardcore/clean stone.

Minimum bar reinforcement lap lengths:
T10 = 350mm
T12 = 450mm
T16 = 550mm
T20 = 650mm

Minimum fabric reinforcement lap lengths:
A393 = 400mm

THIS DRAWING TO BE READ IN CONJUNCTION WITH LATEST BUILDING REGULATION DRAWINGS AND DETAILS

SAFE GROUND BEARING PRESSURE = 130KN/M² FOR RETAINING WALL BASE - SEE MURRAY RIX REPORT.

Client	Mr. and Mrs. W. Mallard	
Job	Proposed New Dwelling at Gerrards Hollow, Gee Cross, Sk14 5DT.	
Drg	Proposed Foundation and Reinforced Concrete Retaining Wall Details.	
Drawn	Date	Scale
S.King	Dec. 2023	As Shown
Job No.	Drg No.	
C23.07.32	Sketch02	

Gamble King and Noone Ltd
Consulting Structural Engineers & Building Surveyors.
5 Queen Street
Oldham
OL1 1RD
Tel: 0161 652 1183
Mobile: 07756 902 604
07725 145 369