

ALL DIMENSIONS TO BE CHECKED AND CONFIRMED ON SITE

Apethorn Lane

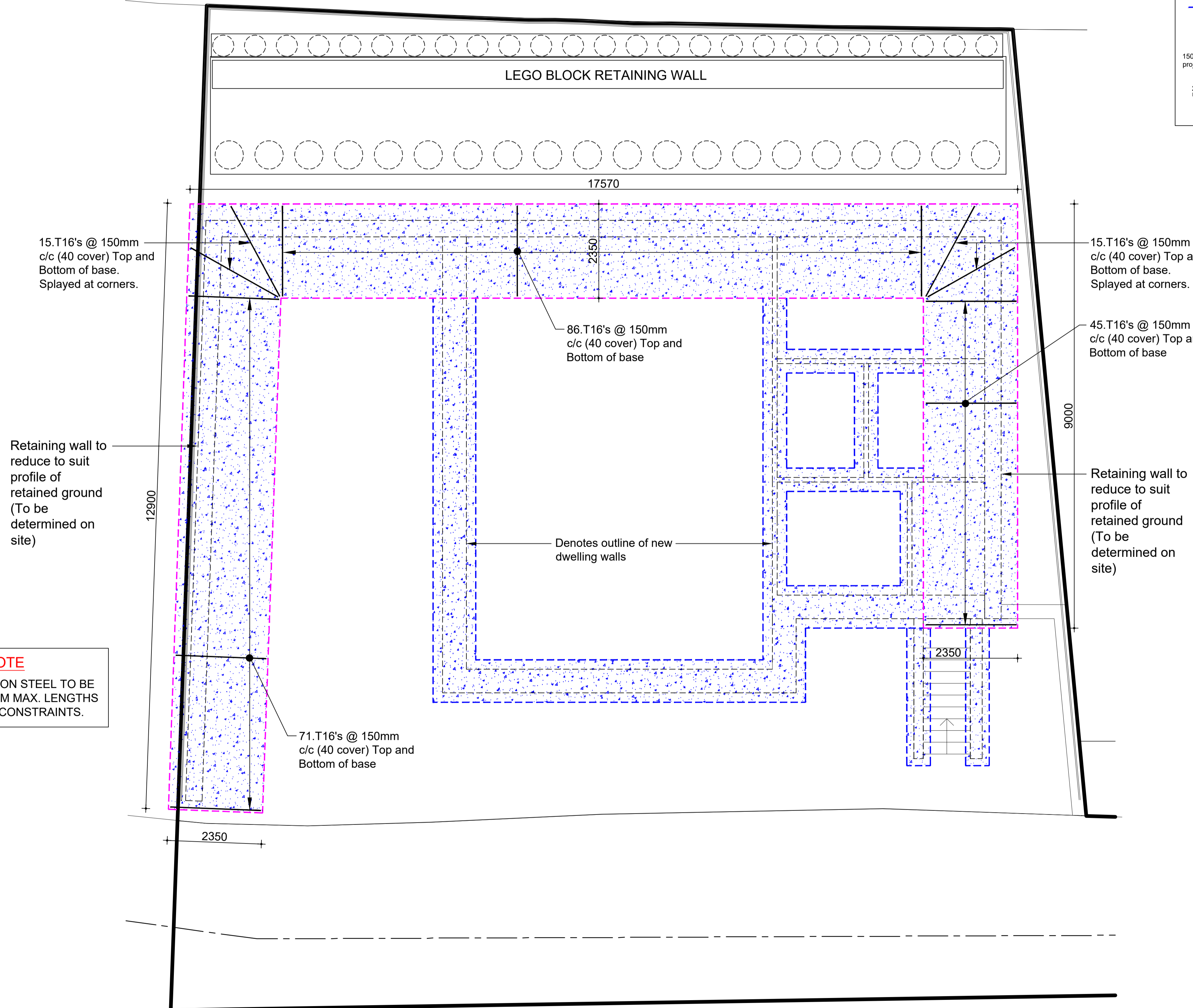

LEGEND

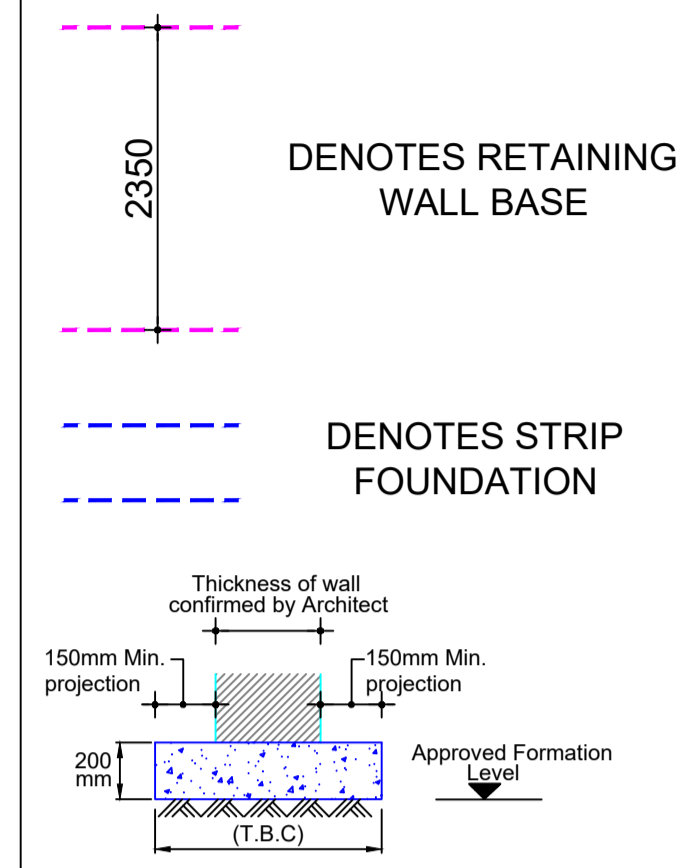

GENERAL NOTES

All dimensions are in millimetres unless otherwise noted.

Contractor to be responsible for checking all dimensions on site prior to work commencing.

All work to be carried out in accordance with British Standards and Codes of Practice.

Contractor to be responsible for all necessary temporary support and bracing to ensure stability of the building during the

RETAINING WALL
Concrete to be grade C35 having a crushing strength of 35N/mm² at 28 days.

Cement content to be 300kg/m³.

Aggregate to be 20mm maximum size.
Max. free water/cement ratio to be 0.60.
High yield reinforcement T bars to be type 2 bond bars as described in BS8110 with a characteristic tensile strength of 460N/mm².

Test cubes to be taken as directed by the Engineer.

All concrete to be compacted to the specification or by the means approved by the Engineer.

Concrete cover to be 50mm.
Filling behind wall to be lightly compacted free draining hardcore/clean stone.
Minimum bar reinforcement lap lengths :
T10 = 350mm
T12 = 450mm
T16 = 550mm
T20 = 650mm

Minimum fabric reinforcement lap lengths :
A393 = 400mm

THIS DRAWING TO BE READ IN CONJUNCTION WITH LATEST BUILDING REGULATION DRAWINGS AND DETAILS

BUILDERS NOTE

T12 DISTRIBUTION STEEL TO BE ORDERED IN 6.0M MAX. LENGTHS DUE TO SITE CONSTRAINTS.

SAFE GROUND BEARING PRESSURE = 130KN/M² FOR RETAINING WALL BASE - SEE MURRAY RIX REPORT.

Client
Mr. and Mrs. W. Mallard

Job
Proposed New Dwelling at Gerrards Hollow, Gee Cross, Sk14 5DT.

Drg
Proposed Retaining Wall Base Reinforcement Details.

| | | |
|----------------------|---------------------|-------------------|
| Drawn S.King | Date Dec. 2023 | Scale As Shown |
| Job No. C23.07.32 | Drg No. Sketch03 | |

Gamble King and Noone Ltd
Consulting Structural Engineers & Building Surveyors.
5 Queen Street
Oldham
OL1 1RD
Tel: 0161 652 1183
Mobile: 07756 902 604
07725 145 369

Proposed Retaining Wall Base Reinforcement Details (1:50)