

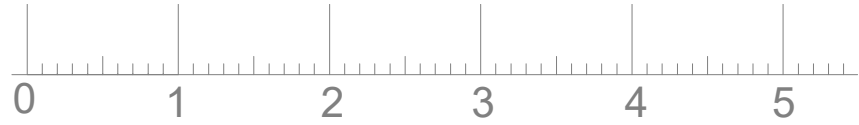

NEW REPLACEMENT WINDOWS

PROPOSED NORTH ELEVATION



SCALE IN METERS 1:50

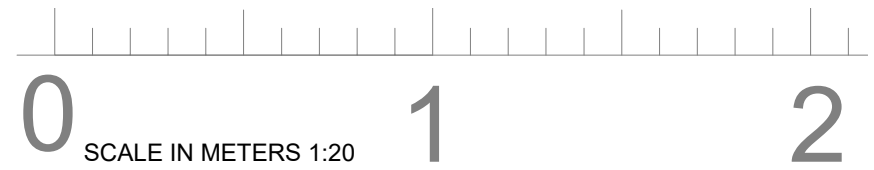

SCALE IN METERS 1:20

NEW REPLACEMENT WINDOWS

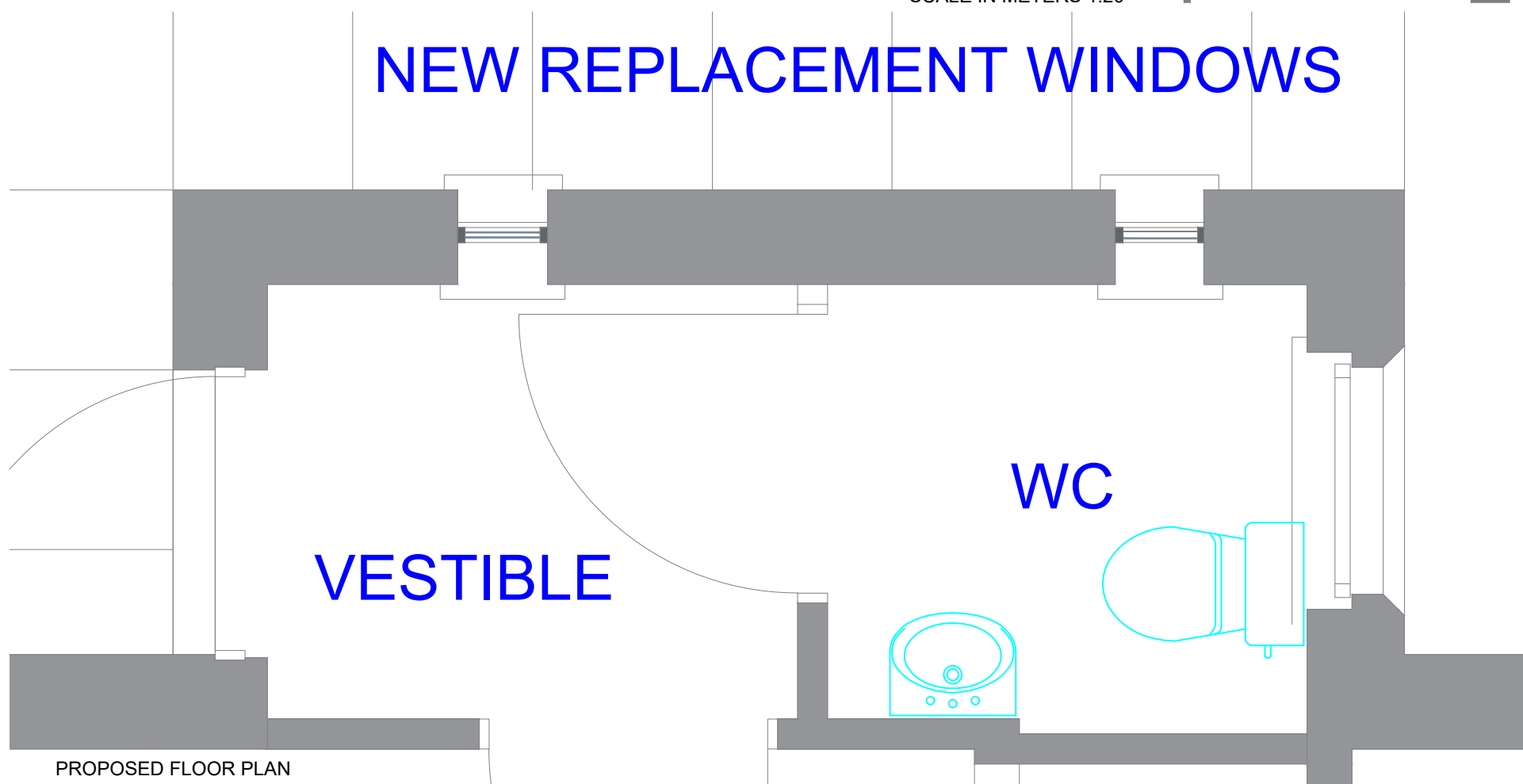

VESTIBULE

WC

PROPOSED FLOOR PLAN

PROPOSED REPLACEMENT WINDOWS

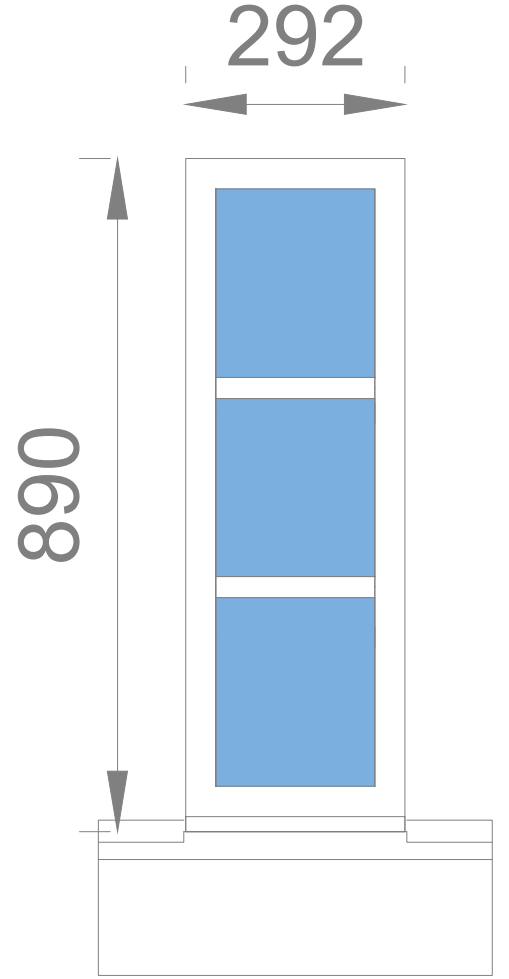

292

890

NEW WINDOWS
 External fixed lights
 Alitherm Heritage Aluminium - Black
 with Aluminium cill - Black
 28mm Low E Argon Double glazing
 clear glass

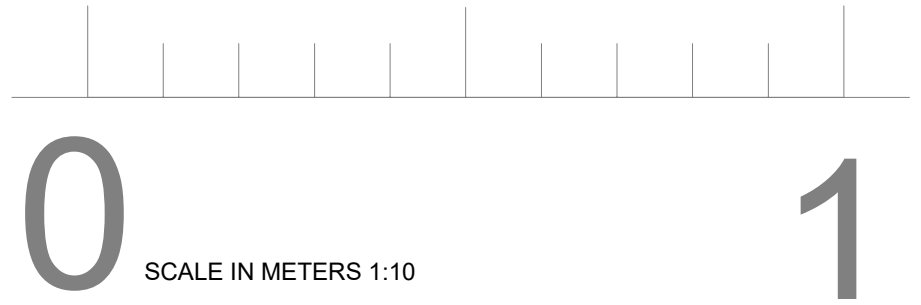

SCALE IN METERS 1:10

ST MARY'S EPISCOPAL CHURCH
 PROPOSED
 REPLACEMENT OF RAILINGS AT BASEMENT
 STEPS
 REPLACEMENT METAL WINDOWS TO VESTIBULE
 VESTIBULE
 NEW ACCESS DOOR TO HALL
 DUNBLANE
 PROPOSED REPLACEMENT WINDOWS

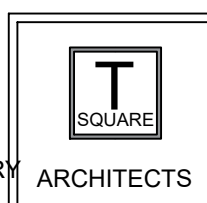

Architecture - Design - Planning
 Castle View, Steuart Road
 Bridge of Allan
 Stirling
 FK9 4JX
 Mob: 07596906412
 E-mail: claire.gibbons@tsquare-architects.co.uk Web: www.tsquare-architects.co.uk

scale 1:50, 1:20, 1:10	date 02.03.24	drawn CG	status P
proj no. 2024-1061	Dwg no. T-401A	REV	