

EXISTING SIDE ELEVATION

ST MARY'S EPISCOPAL CHURCH  
 PROPOSED  
 REPLACEMENT OF RAILINGS AT BASEMENT  
 STEPS  
 REPLACEMENT METAL WINDOWS TO VESTRY  
 VESTIBLE  
 NEW ACCESS DOOR TO HALL  
 DUNBLANE  
 EXISTING RAILINGS

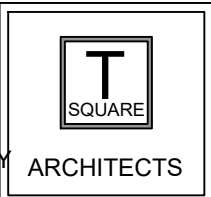

Architecture - Design - Planning  
 Castle View, Steuart Road  
 Bridge of Allan  
 Stirling  
 FK9 4JX  
 Mob: 07596906412  
 E-mail: claire.gibbons@tsquare-architects.co.uk Web: www.tsquare-architects.co.uk

scale	1:50 1:20	date	02.03.24	drawn:	CG	status:	P
proj no.	2024-1061	Dwg no.	T-301B	REV			