

**UK  
Planning  
Maps**

01856 898 022  
www.UKPlanningMaps.com

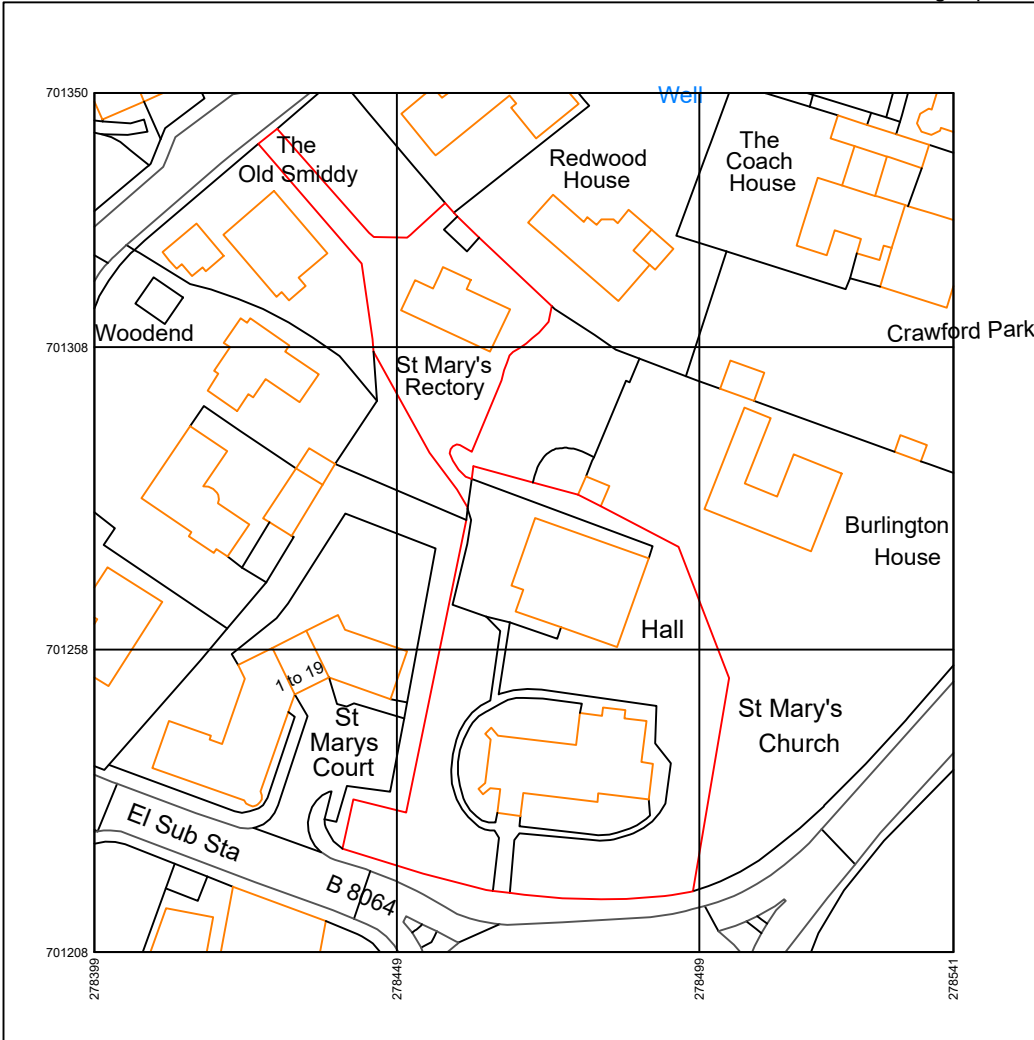

Produced on 12 April 2024 from the Ordnance Survey National Geographic Database and incorporating surveyed revision available at this date.  
This map shows the area bounded by 278399 701208,278541 701208,278541 701350,278399 701350,278399 701208  
Crown copyright and database rights 2024 OS 100054135. Supplied by copla ltd trading as UKPlanningMaps.com a licensed Ordnance Survey partner (OS 100054135).  
Data licence expires 12 April 2025. Unique plan reference: v2e//1085640/1461573

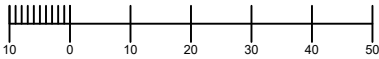

**ST MARY'S EPISCOPAL CHURCH**

**PROPOSED  
REPLACEMENT OF RAILINGS AT BASEMENT  
STEPS  
REPLACEMENT METAL WINDOWS TO VESTRY  
VESTIBLE**

**NEW ACCESS DOOR TO HALL**

**DUNBLANE  
LOCATION PLAN**

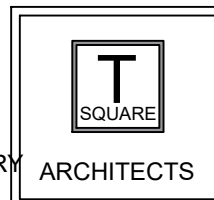

Architecture - Design - Planning

Castle View, Steuart Road  
Bridge of Allan  
Stirling  
FK9 4JX

Mob: 07596906412

E-mail: daire.gibbons@tsquare-architects.co.uk Web: www.tsquare-architects.co.uk

scale 1:1250	date 02.03.24	drawn: CG	status: P
proj no. 2024-1061	Dwg no. T-101	REV -	