

Tom Nemeth

---

From: dcplanning  
Sent: 07 May 2024 09:52  
To: Tom Nemeth  
Subject: Fw: [EXTERNAL] Re: Planning Application Incomplete - 24/00971/PNO

Regards Stuart  
Development Management  
Chichester District Council

[dcplanning@chichester.gov.uk](mailto:dcplanning@chichester.gov.uk) | [www.facebook.com/ChichesterDistrictCouncil](https://www.facebook.com/ChichesterDistrictCouncil) | [www.twitter.com/ChichesterDC](https://www.twitter.com/ChichesterDC)

---

From: Tara Mee [REDACTED]  
Sent: 07 May 2024 09:26  
To: dcplanning <dcplanning@chichester.gov.uk>  
Subject: [EXTERNAL] Re: Planning Application Incomplete - 24/00971/PNO

This Message originated outside your organization.

Please see all you requested

Address was correct

Plot 2 Ham Road Siddlesham

My plot outlined in red plot 2 with scale

Plan and size of container drawing 9.75 meters x 3.05 sorry had it in feet before

As already stated it will be used for storage of equipment ,workshop planting storage of feed animals and toilet facility as nothing is in area. .

The site location will be at the top end of the plot North end blue lines thin where situated .

---

LEGAL DISCLAIMER

Communications on or through Chichester District Council's computer systems may be monitored or recorded to secure effective system operation and for other lawful purposes.

Unit no 916 - Copy 45



TOTAL AREA: 29.53 m<sup>2</sup> - FLOORS: 1 - ROOMS: 3

▼ Canteen

TOTAL AREA: 29.53 m<sup>2</sup> - FLOORS: 1 - ROOMS: 3

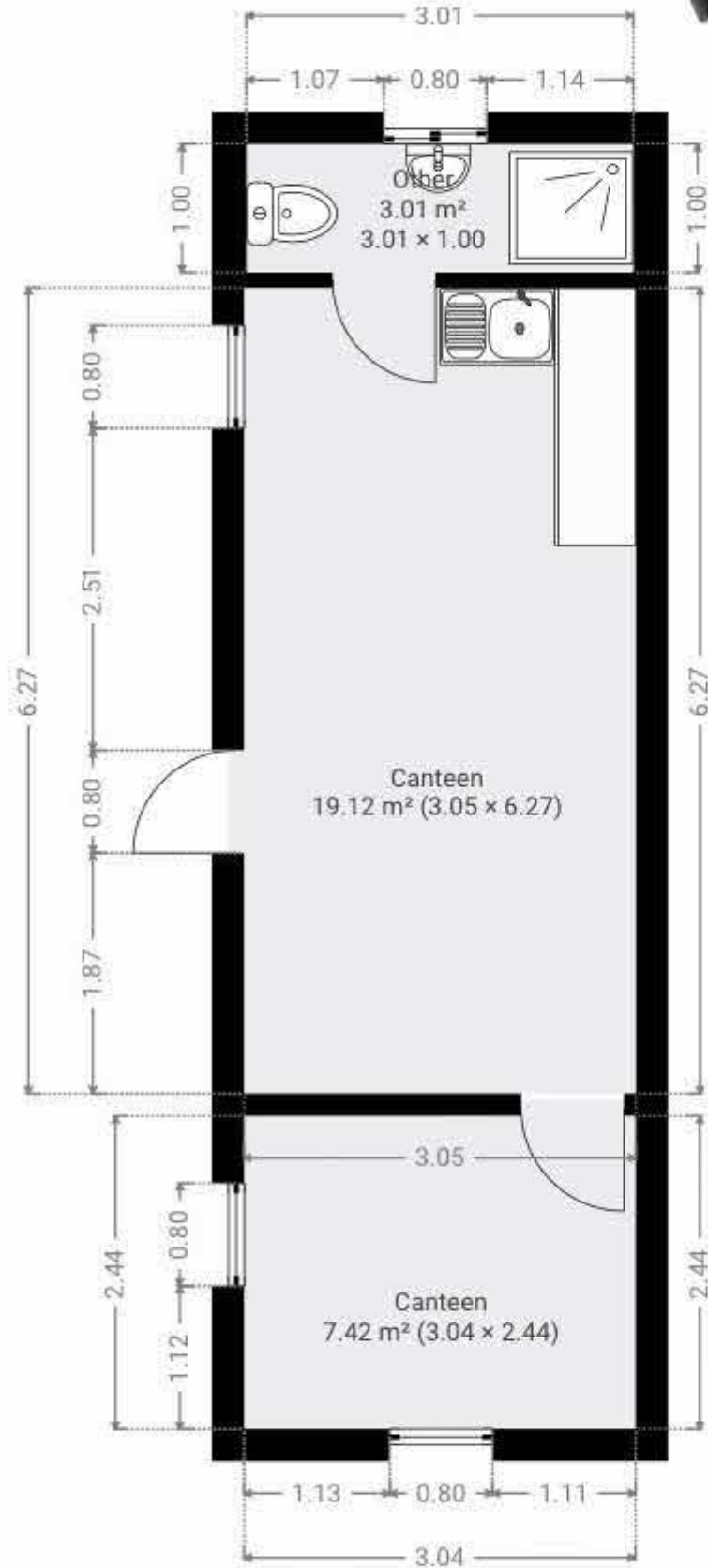

THIS FLOORPLAN IS PROVIDED WITHOUT WARRANTY OF ANY KIND. SENSOPIA DISCLAIMS ANY WARRANTY INCLUDING, WITHOUT LIMITATION, SATISFACTORY QUALITY OR ACCURACY OF DIMENSIONS.

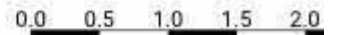



DocuSigned by:  
  
20089964505442

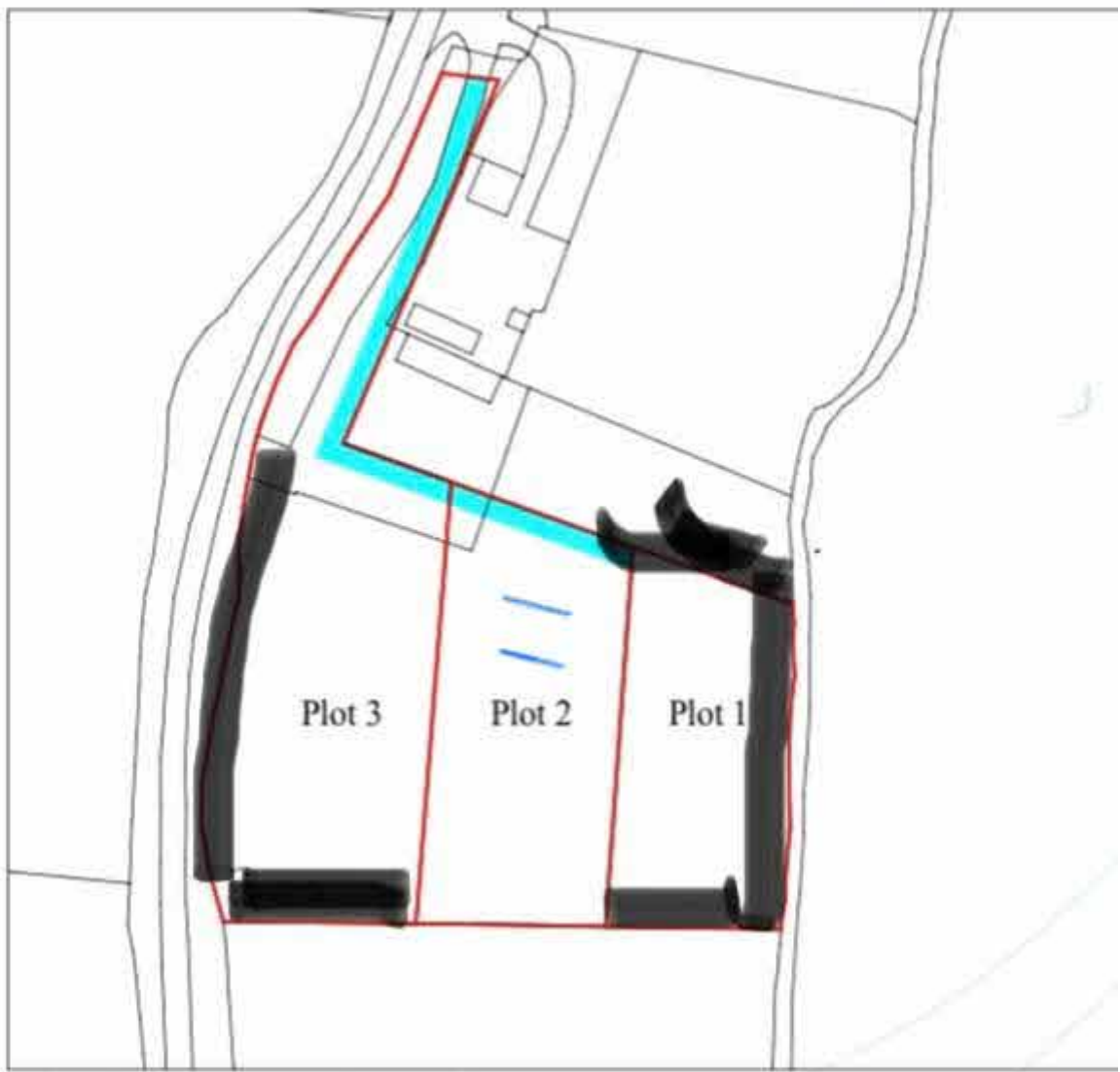

(c) Crown Copyright and Database Rights 2024 OS 100060020

> On 3 May 2024, at 10:09, dcplanning@chichester.gov.uk wrote:

>

> Please see attached document

>

> 

---

LEGAL DISCLAIMER

>

> This e-mail and any files transmitted with it are confidential and intended solely for the use of the individual or entity to whom they are addressed. However, any views or opinions presented are solely those of the author and do not necessarily represent those of Chichester District Council.

>

> If you are not the intended recipient or the person responsible for delivering the e-mail to the intended recipient, be advised that you have received this e-mail in error and that any use, dissemination, forwarding, printing or copying of this e-mail is strictly prohibited.

>

> Communications on or through Chichester District Council's computer systems may be monitored or recorded to secure effective system operation and for other lawful purposes.

>

> If you have received this e-mail in error please notify the Chichester District Council administrator.

>

> E-mail or phone 44 (0) 1243 785166

> [contact@chichester.gov.uk](mailto:contact@chichester.gov.uk)

> <ufm2\_INVAPZ\_-\_Invalid\_Application\_Letter+.pdf>