

2. All sizes to be checked on site prior to construction.  
 3. This drawing is the copyright of the author.

- Key:**
- Proposed porcelain paving slabs
  - Proposed planter with integrated storage

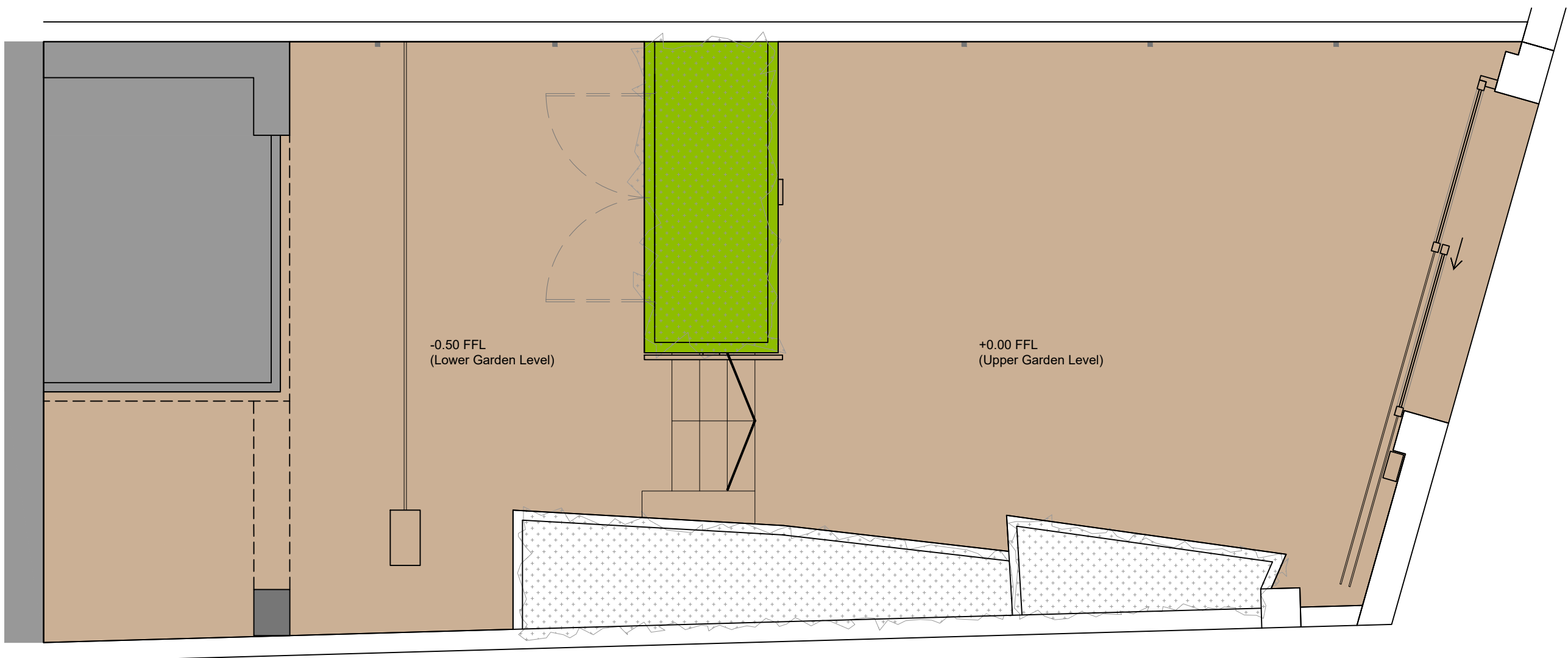

**PROPOSED PORCELAIN PAVING SLAB**  
**PROPOSED SURFACE FINISHES PLAN**

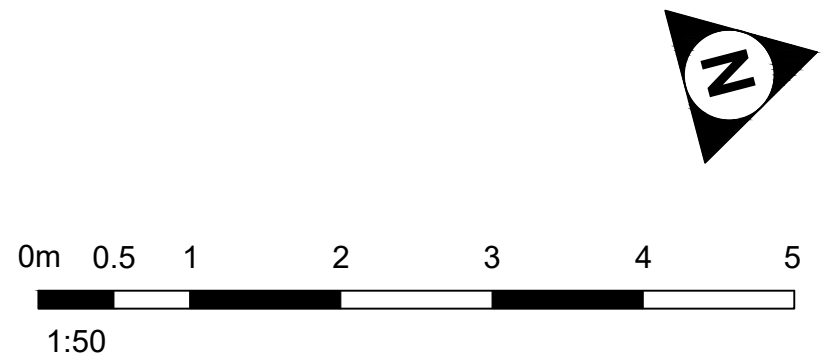

3	01.05.2024	PLANNING ISSUE	KL
2	23.04.2024	TENDER ISSUE	KL
1	26.08.2023	PLANNING ISSUE	KL

**LEE STUDIO**  
 shooloong@me.com

28 Salmons Street, Glasgow, G22 5NZ. 07766 163 130  
 drawing original size

**16 WESTBOURNE GARDENS**  
**Proposed Surface Finishes Plan**  
 A3

scale 1:50 drawn KL

date 26.08.2023 checked -

status PLANNING passed -

job no.	drawing no.	revision
2023-05	AL(0)007	3