

Hatch Key:

Coloured areas of hatch on interior Plans and Elevations indicate proposed fixtures, fittings or built fabric, proposed to be inserted, as below:

- (Light Blue) - Proposed to be added, viewed in elevation.
- (Dark Blue) - Proposed to be added, viewed in Section.

For Secondary Glazing Design Intent see drawing For Secondary Glazing Design Intent see drawings 3220-3223

Extent of plaster damaged by moisture ingress requiring replacement.



01 Site Plan
2001 1:500 @ A1

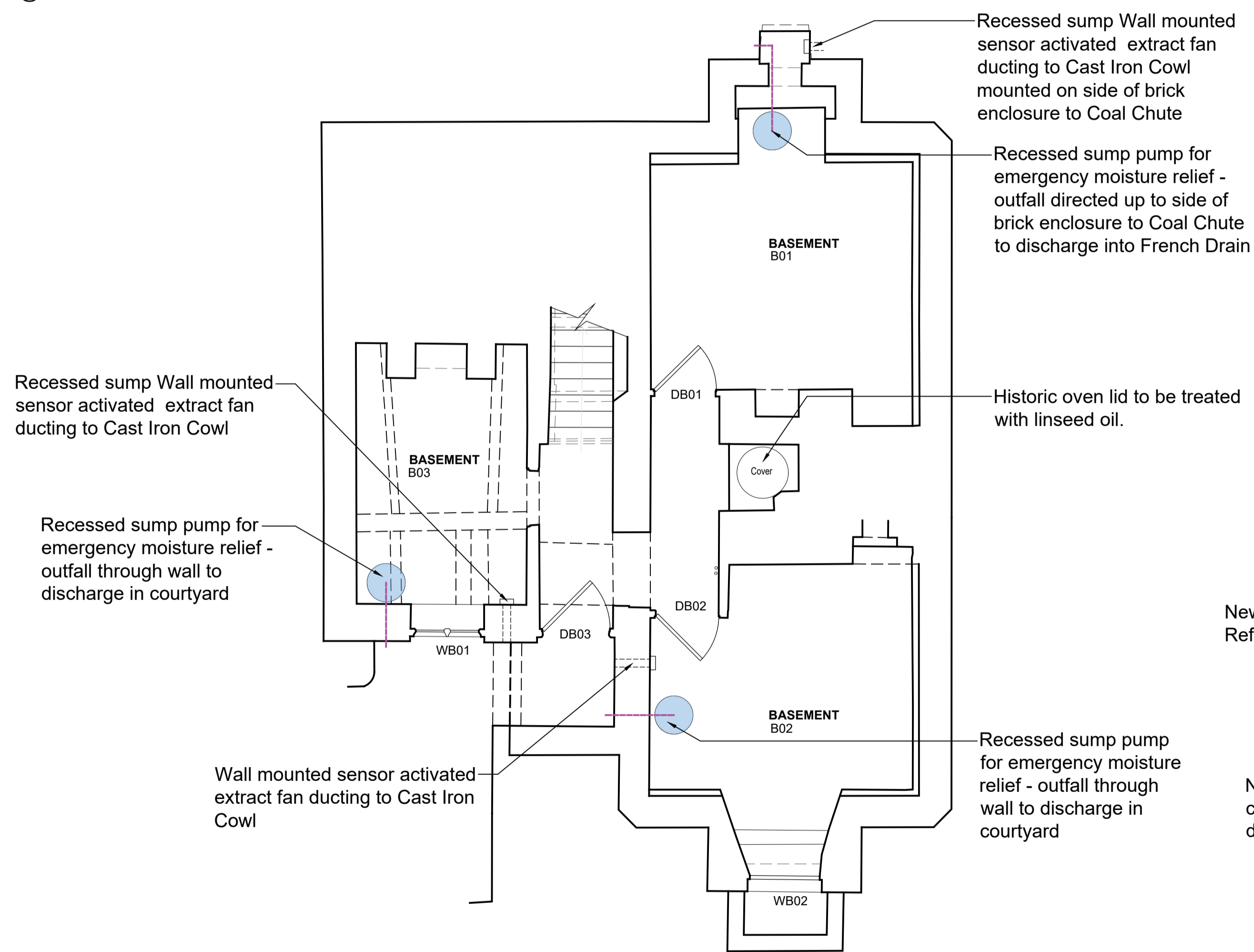

02 Basement Plan
2001 1:50 @ A1

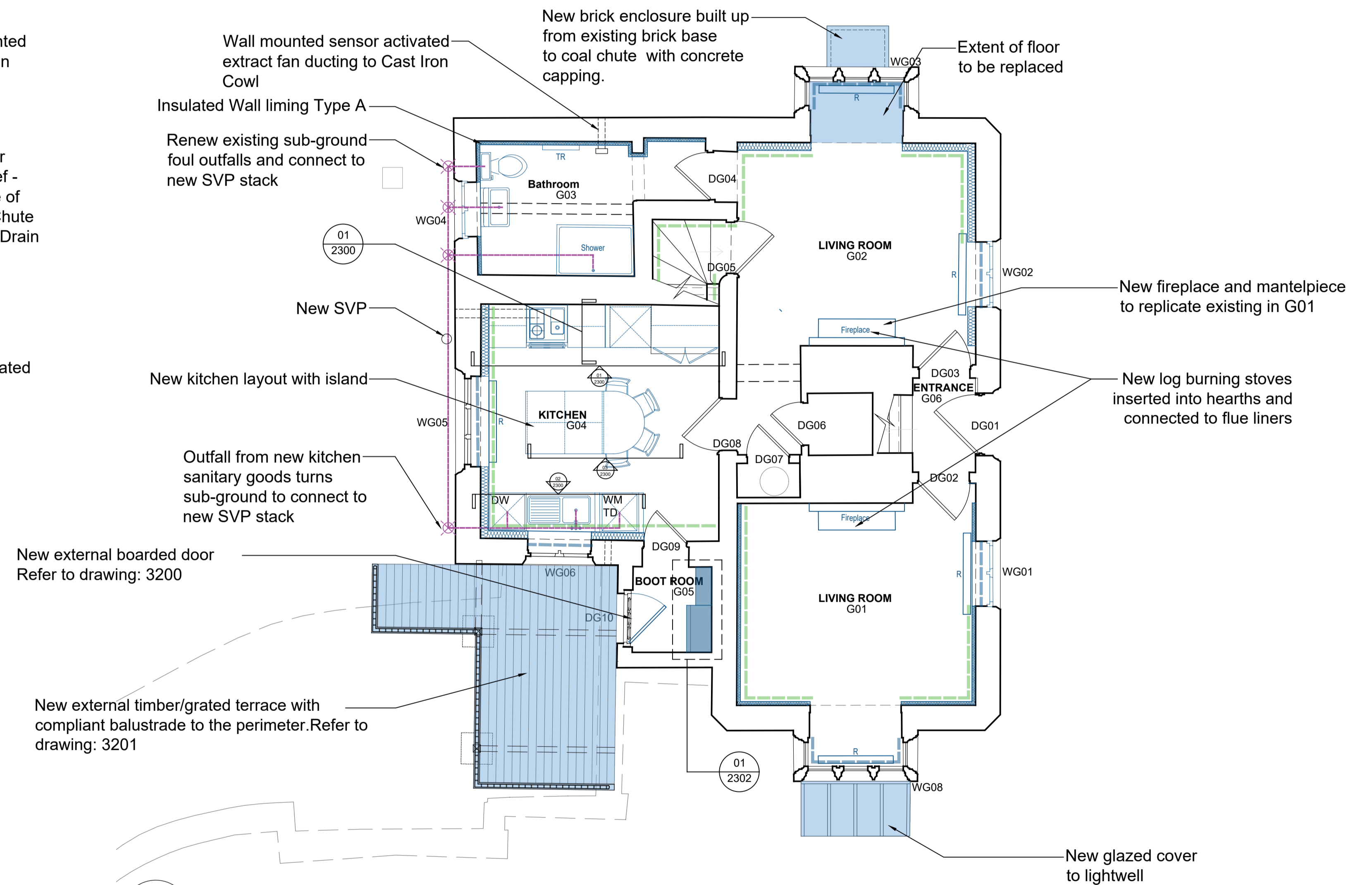

03 Ground Floor
2001 1:50 @ A1

Notes

- Any dwg format drawing is to be read in conjunction with and at the scale of the accompanying pdf.
- Where colours other than black or grey are used, the drawing must be plotted in colour.
- For status 'C' (Construction) drawings all dimensions are to be checked on site by the contractor, scaling is for Local Authority purposes only.
- Unless otherwise indicated, all dimensions are in millimeters.
- All information on this drawing is to be read in conjunction with the relevant Donald Insall Associates specification and trade contractors' drawings and information by specialists.
- In the event of any discrepancy, please contact us immediately.
- This drawing may contain survey information by others and is to be used solely for the purposes for which it was issued.
- These are uncontrolled documents issued for information purposes only. If you have any queries regarding the drawings, please contact DIA immediately.
- Please note DIA cannot be held responsible for any errors arising from changes made to an uncontrolled dwg file.

© 2019 DONALD INSALL ASSOCIATES LTD

| Rev | Date | Dwn | Auth | Revision |
|-----|------------|---------|------|--|
| 4 | 19-04-2024 | TXH | | Replacement timber windows and extent of plaster replacement indicated |
| 3 | 05-04-2024 | TXH | | Secondary glazing omitted from WG04 |
| 2 | 20-03-2024 | ECL TXH | | G03 bathroom layout, insulation wall lining, mantelpiece |
| 1 | 14-12-2023 | HXA TXH | | Issued for design and cost estimation purposes |
| 0 | 11-01-2023 | LXW TB | | Issued for Planning and Listed Building Consent |

Donald Insall Associates
Chartered Architects and Historic Building Consultants

Bridgiate House, 5 Bridge Place
Chester CH1 1SA
(+44) 01244 350 063
chester@insall-architects.co.uk

Paradise Lodge, Hodnet

Basement and Ground Floor Plans
As Proposed

| | | | |
|------------|--------|----------|------|
| Project | HPC.01 | No | 2001 |
| Scale (A1) | 1:50 | Status | 4M |
| | | Revision | 4 |