

WINDOW SCHEDULE - GROUND FLOOR							
Window ref	Location	Width	Height	Material	Type	Colour	Glazing
WH1	Reception (North elevation)	0.510m	1.560m	Timber	Sash & Case	White	Conservation double glazed 2 Pane Sash
WH2	Reception (North elevation)	0.510m	1.560m	Timber	Sash & Case	White	Conservation double glazed 2 Pane Sash
WH3	Reception (West elevation)	0.910m	1.560m	Timber	Sash & Case	White	Conservation double glazed 6 Pane Sash
WH4	Reception (West elevation)	0.910m	1.560m	Timber	Sash & Case	White	Conservation double glazed 6 Pane Sash
WH5	Dining Room (North elevation)	1.070m	1.940m	Timber	Sash & Case	White	Conservation double glazed 6 Pane Sash
WH6	Dining Room (North elevation)	1.070m	1.940m	Timber	Sash & Case	White	Conservation double glazed 6 Pane Sash
WH7	Dining Room (West elevation)	0.585m	1.940m	Timber	Sash & Case	White	Conservation double glazed 2 Pane Sash
WH8	Dining Room (West elevation)	0.585m	1.940m	Timber	Sash & Case	White	Conservation double glazed 2 Pane Sash
WH9	Dining Room (West elevation)	0.585m	1.940m	Timber	Sash & Case	White	Conservation double glazed 2 Pane Sash
WH10	Dining Room (South elevation)	1.070m	1.940m	Timber	Sash & Case	White	Conservation double glazed 6 Pane Sash
WH11	Bathroom (West elevation)	2.150m	0.630m	Timber	Sash & Case	White	Conservation double glazed single Pane Sash
WH12	Bathroom (West elevation)	2.150m	0.630m	Timber	Sash & Case	White	Conservation double glazed single Pane Sash
WH13	Bathroom (West elevation)	2.150m	0.630m	Timber	Sash & Case	White	Conservation double glazed single Pane Sash
WH14	Bathroom (West elevation)	2.150m	0.630m	Timber	Sash & Case	White	Conservation double glazed single Pane Sash
WH15	Bathroom (West elevation)	2.150m	0.630m	Timber	Sash & Case	White	Conservation double glazed single Pane Sash
WH16	Bathroom (West elevation)	2.150m	0.630m	Timber	Sash & Case	White	Conservation double glazed single Pane Sash
WH17	Bathroom (West elevation)	2.150m	0.630m	Timber	Sash & Case	White	Conservation double glazed single Pane Sash
WH18	Bathroom (West elevation)	2.150m	0.630m	Timber	Sash & Case	White	Conservation double glazed single Pane Sash
WH19	Bathroom (South elevation)	2.150m	0.630m	Timber	Sash & Case	White	Conservation double glazed 2 Pane Sash
WH20	Bathroom (South elevation)	2.150m	0.630m	Timber	Sash & Case	White	Conservation double glazed 2 Pane Sash
WH21	Bathroom (South elevation)	2.150m	0.630m	Timber	Sash & Case	White	Conservation double glazed 2 Pane Sash
WH22	Kitchen (South elevation)	1.810m	1.910m	Timber	Casement (Tilt & Turn)	White	Tilt & Turn toughened double glazed
WH23	Kitchen Store (South elevation)	0.890m	1.500m	PVC	Casement (Tilt & Turn)	White	Tilt & Turn toughened double glazed
WH24	Kitchen Prep (East elevation)	1.050m	1.450m	PVC	Casement (Tilt & Turn)	White	Tilt & Turn toughened double glazed
WH25	Laundry (North elevation)	1.050m	1.450m	PVC	Casement (Tilt & Turn)	White	Tilt & Turn toughened double glazed

DOOR SCHEDULE - GROUND FLOOR							
Door ref	Location	Width	Height	Material	Glazing	Colour	Glazing
DH1	Hotel Entrance (West elevation)	1.380m	2.040m	Timber	double glazed	White	Double glazed with toughened glass
DH2	Bathroom Entrance (West elevation)	1.750m	2.300m	Timber	double glazed	White	Double glazed with toughened glass
DH3	Kitchen (South elevation)	1.420m	2.330m	Timber	double glazed	White	Solid single panel with vision pane
DH4	Kitchen Store (East elevation)	1.050m	2.100m	Timber	No	White	Solid single panel
DH5	Laundry (North elevation)	1.210m	2.100m	Timber	No	White	Solid single panel
DH6	Rear Store (East elevation)	0.930m	2.100m	Timber	No	White	Solid single panel

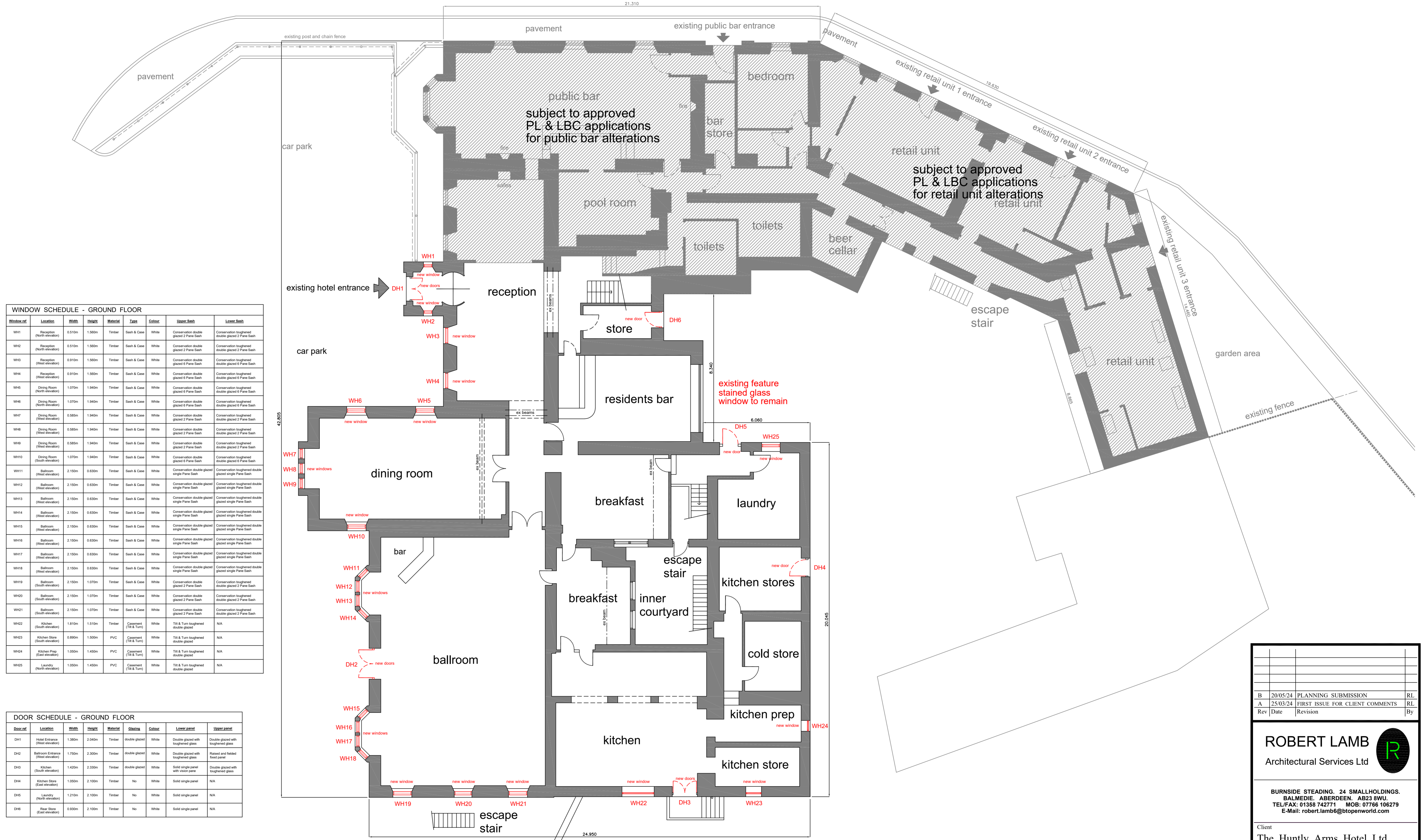

PROPOSED GROUND FLOOR PLAN. 1:100.

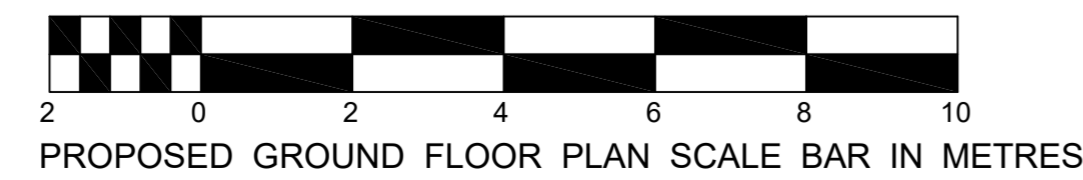

Rev	Date	Revision	By
B	20/05/24	PLANNING SUBMISSION	RL
A	25/03/24	FIRST ISSUE FOR CLIENT COMMENTS	RL

ROBERT LAMB
Architectural Services Ltd

BURNSIDE STEADING, 24 SMALLHOLDINGS,
BALMORIE, ABERDEEN, AB23 3WU
TEL/FAX: 01358 742771 MOB: 07766 106279
E-Mail: robert.lamb6@btopenworld.com

Client The Huntly Arms Hotel Ltd		
Project Proposed replacement windows and doors to main hotel in existing building at Charlestown Road, Aboyne.		
Description Proposed ground floor plan		
Project No THAH/24/01	Drawing No PL005	Amendment B
Scale as shown @ A1	Date 18/03/24	Drawn By RGL
Computer File Ref	Checked By	Status PLANNING

This drawing is the sole copyright of Robert Lamb and should not be copied or reproduced in any way without prior consent from Robert Lamb