

DRAWING NOTES:

All items, notes dimension and general design contained in this drawing are for guidance purposes only. Nominated builder and person responsible for the project should make a thorough check prior to commencement of works against the site, drainage service drawings, current building regulations, British Standards and codes of practice, the contractor is to allow within their price for all items not listed but that will be required to complete the work in accordance with all current legislation.

The copyright in all designs / drawings prepared by Kirkwood shall remain the property of Kirkwood and must not be reissued / loaned or copied without prior consent.

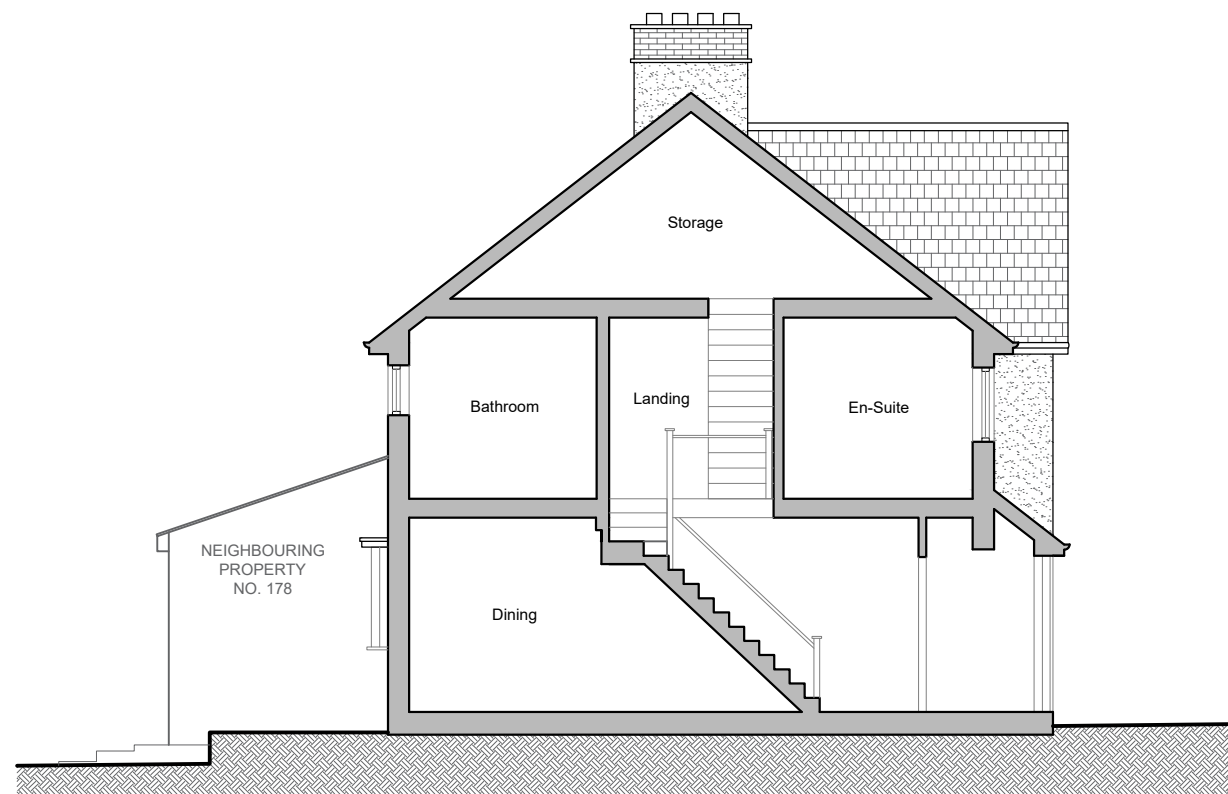

7 Existing Section A-A
1:100 - Rear to Front

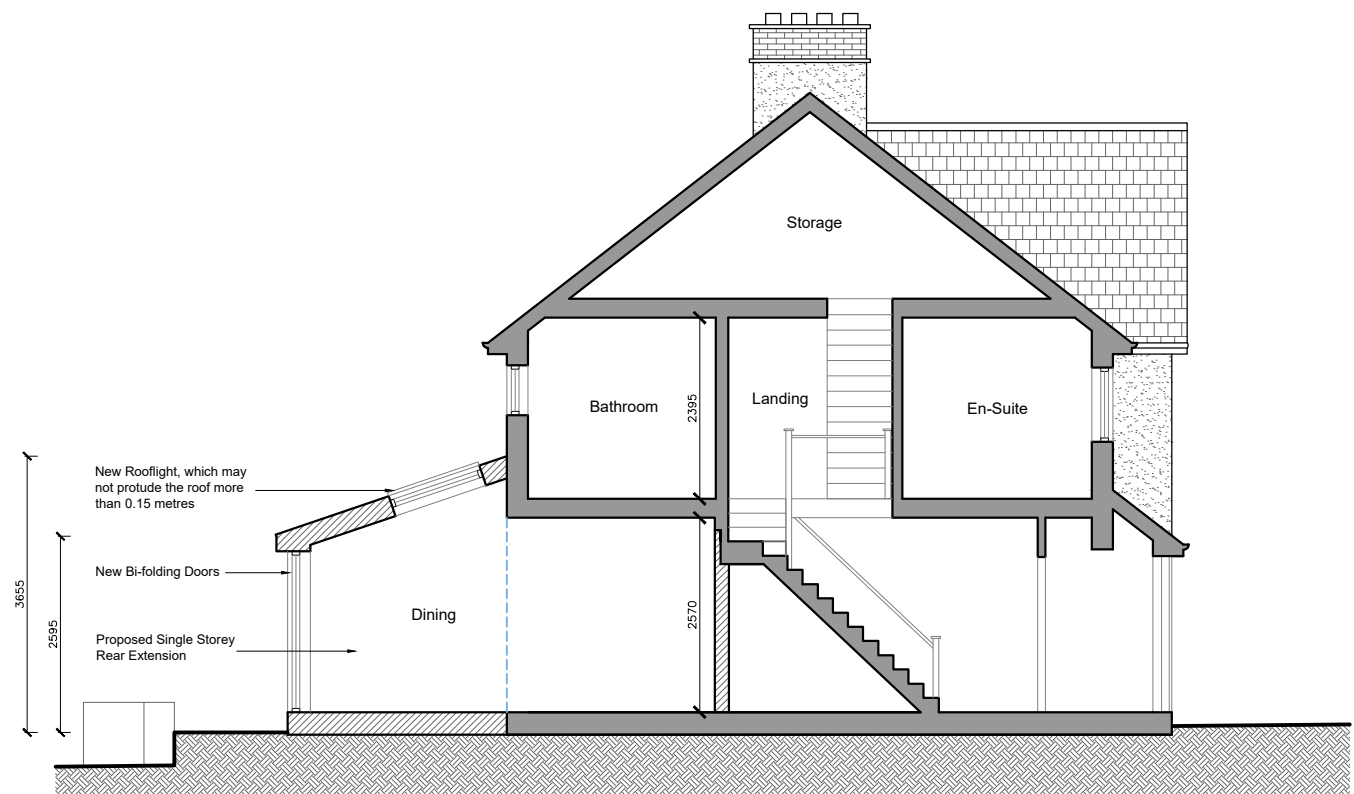
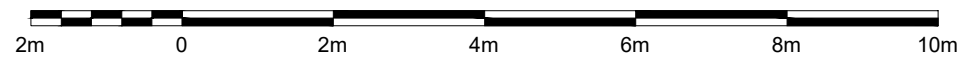

8 Proposed Section A-A
1:100 - Rear to Front

KEY		
	Existing	
	Proposed	
	Ex Build Line	
	Boundary	

Exterior Ridge Height
+ 8.187m
Interior Ridge Height
+ 7.987m

Second Floor Level
+ 5.465m
First Floor CH
+ 5.215m

First Floor Level
+ 2.820m
Ground Floor CH
+ 2.570m

Ground Floor Level
+ 0.000m

REV	DESCRIPTION	BY	DATE
kirkwood better your home			
CLIENT: Suzanna & Samuel White			
SITE: 176 Priests Lane, Brentwood, Essex, CM15 8HT			
TITLE: Existing and Proposed Cross Section			
SCALE AT A3: 1:100	DATE: MAR 24	DRAWN BY: NP	
PROJECT NO: -	DRAWING NO: 06	REVISION: A	