

**CHEFFINS**

Promap  
LANDMARK INFORMATION  
Ordnance Survey, © Crown Copyright 2010. All Rights Reserved.  
License number 100021832  
Printed Scale - 1:2500 Paper Size - A4

# site identification plan

## 1:2500 (red line plan)

Showing application site for 'Change of Use' from sole agricultural use, to mixed agricultural and equine use, as an extension to the existing '2 Acre' Paddock which has existing approved mixed agricultural and equine use.

- denotes application site, Extension to existing Paddock
- denotes land under applicants ownership

**Site of Application**  
Extension to existing paddock adjacent to No.2 Orchard Lane Woodnewton PE8 5EE

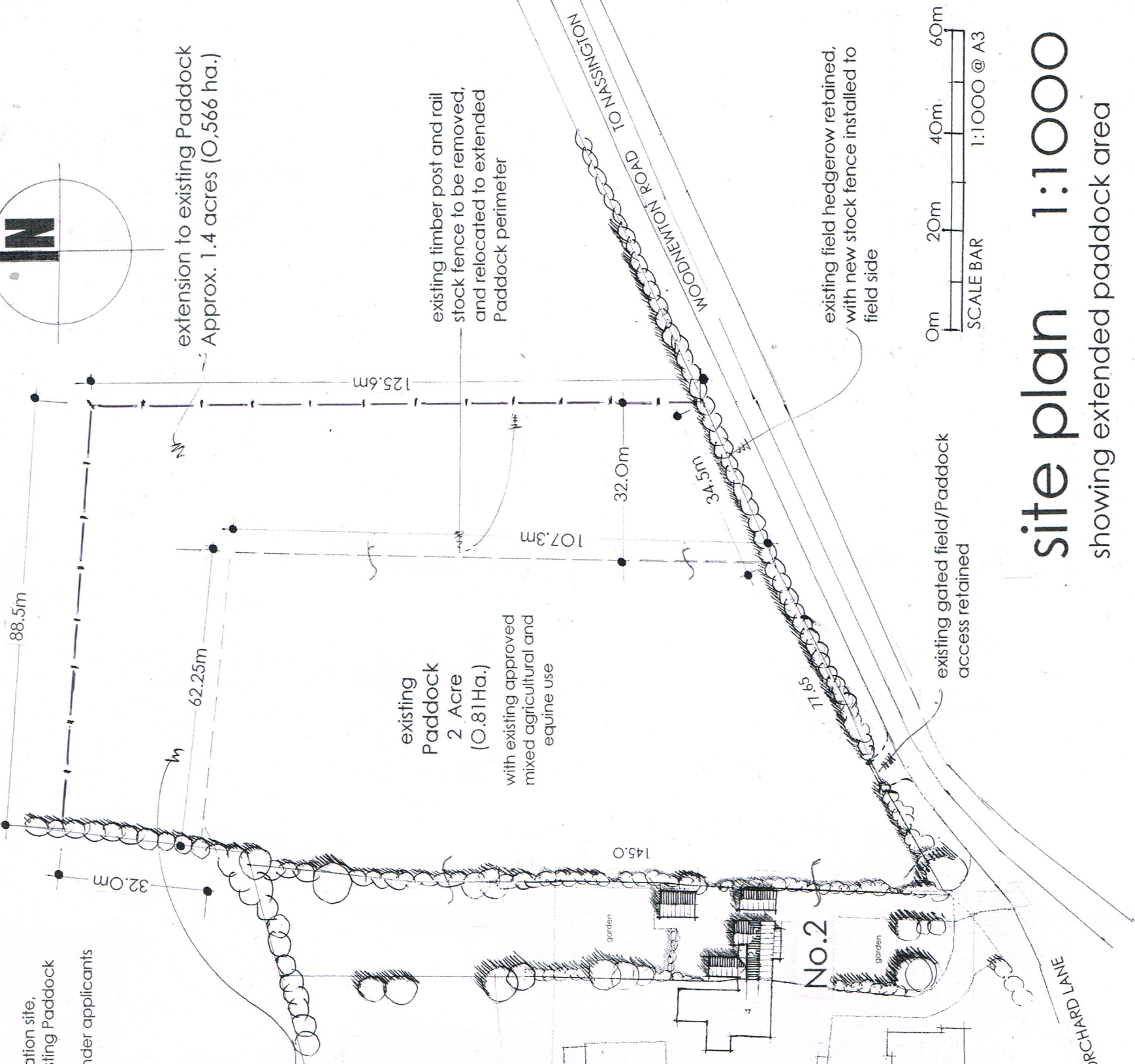

# site plan 1:1000

showing extended paddock area

**GRIFFIN ASSOCIATES**  
Oundle Peterborough

mob: 07850 085320

title location and site plan  
 scale 1:2500 1:1000  
 date 04/24  
 drawing no 1564 - EQ2 - 01  
 rev.

PROPOSED CHANGE OF USE OF LAND  
 TO MIXED AGRICULTURAL AND EQUINE USE  
 TO PROVIDE EXTENSION TO EXISTING PADDOCK